



PRODUCT CATALOGUE



WIJAS S.J. is a family-run business established in 1971. Initially it provided only tooling services. In 1980 the production of household appliances commenced. In 1998 WIJAS S.J. started to produce PERFECT water heaters. Owing to continuous improvements of our products, water heaters manufactured by us are characterised by reliability, high-quality workmanship and small dimensions. The company undergoes a continuous modernisation. It upgrades the machinery, introduces new technologies in the production process and develops the sales net. Only high quality components of renowned manufacturers are used. Each water heater is subject to strict quality control before it leaves the final assembly department. Moreover, we own an extensive service network which consists of 200 centres. Our products were highly esteemed by our customers. We received twice the prestigious Consumer Laurel award.



POLAND
26-026 Morawica
Bilcza, ul. Szafrkowa 35

tel.: + 48 41 302-26-10
tel.: + 48 41 302-22-32
fax: + 48 41 302-26-12
www.wijas.com.pl
e-mail: biuro@wijas.com.pl



Product catalogue



PERFECT Electronic instantaneous water heater

- Perfect 350
3.5 kW / 230V
- Perfect 400
4.0 kW / 230V
- Perfect 450
4.5 kW / 230V
- Perfect 500
5.0 kW / 230V



PERFECT Electronic instantaneous water heater *suitable for showers*

- Perfect 450P
4.5 kW / 230V
- Perfect 500P
5.0 kW / 230V



POW-LCD MULTI pressure instantaneous water heater

- POW-LCD MULTI
11/13.5/15
11/13.5/15 kW / 400V
- POW-LCD MULTI
18/21/24
18/21/24 kW / 400V



POW-LCD MULTI 2 pressure instantaneous water heater

- POW-LCD MULTI 2
11/13.5/15
11/13.5/15 kW / 400V
- POW-LCD MULTI 2
18/21/24
18/21/24 kW / 400V



PERFECT MIX instantaneous water heater

- Perfect MIX 3.5
3.5 kW / 230V
- Perfect MIX 4.0
4.0 kW / 230V
- Perfect MIX 4.5
4.5 kW / 230V
- Perfect MIX 5.0
5.0 kW / 230V
- Perfect MIX 5.5
5.5 kW / 230V



SMART pressure instantaneous water heater

- SMART 3.5
3.5 kW / 230V
- SMART 4.0
4.0 kW / 230V
- SMART 4.5
4.5 kW / 230V
- SMART 5.0
5.0 kW / 230V



POW-H pressure instantaneous water heater

- POW 12H
12 kW / 400V
- POW 15H
15 kW / 400V
- POW 18H
18 kW / 400V
- POW 21H
21 kW / 400V



PERFECT pressure instantaneous water heater

- Perfect 3500
3.5 kW / 230V
- Perfect 4000
4.0 kW / 230V
- Perfect 4500
4.5 kW / 230V
- Perfect 5000
5.0 kW / 230V
- Perfect 5500
5.5 kW / 230V



PERFECT pressure instantaneous water heater

- Perfect 7000
7.0 kW / 400V
- Perfect 8000
8.0 kW / 400V
- Perfect 9000
9.0 kW / 400V



Faucet
length: 150 mm
210 mm
260 mm



Shower set for PERFECT
instantaneous water heaters

PERFECT 350, 400, 450, 500



PERFECT 350, 400, 450, 500 free-outflow (non-pressure) instantaneous water heaters are intended to supply hot water to washbasins and sinks. These heaters are characterised by ease of assembly and they have a comfortable temperature regulating valve which is uncommon in other heaters of this type. Thanks to a bare heating element, hot water runs immediately after the tap is turned on. Moreover, the device consumes the electricity only during water consumption and it has 98,2% heating capacity. All of the above-mentioned features make these heaters energy-saving. The structure of the heating element protects the device from obstruction resulting from the accumulation of limescale from hard water. PERFECT 350, 400, 450, 500 water heaters incorporate a reed switch water flow sensor and an electronic power switch which are incomparably more durable than the mechanical switches (e.g. relays). As a result, all unreliable mechanical parts used in traditional heaters have been eliminated. Thanks to the incorporation of all these solutions we were able to create the smallest and the most efficient instantaneous water heater on the market.

Application

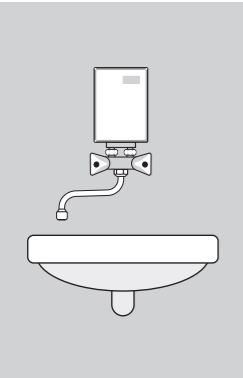

- Washbasin
3.5 kW to 4.5 kW

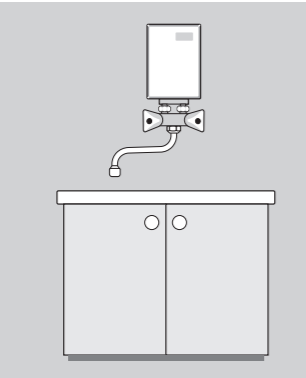

- Sink
4.0 kW to 5.0 kW

Advantages



Solid brass tap



Electronic switch system



Self-cleaning fine-stream aerator

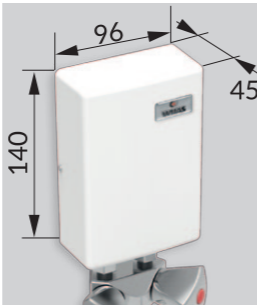

Very small dimensions



Valve to adjust the water temperature

Technical data

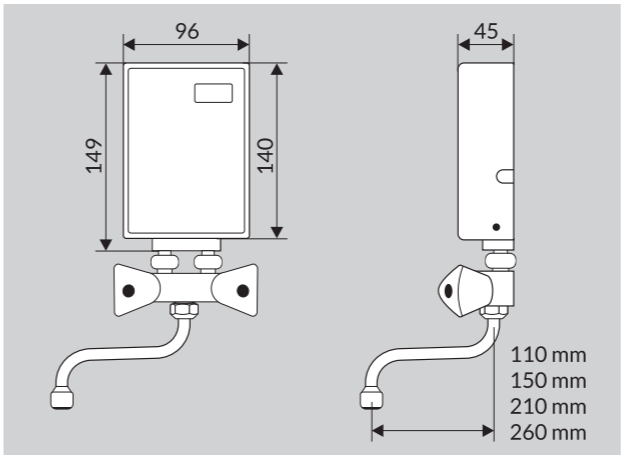

Dimensions

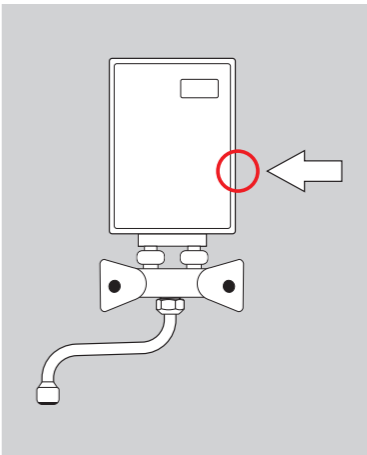

Power supply cable outlet

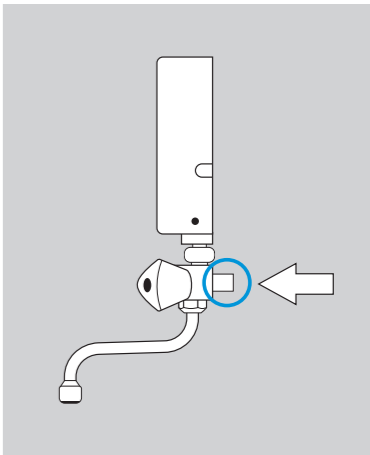

Water connection 1/2"

Heater type	Perfect 350	Perfect 400	Perfect 450	Perfect 500
Voltage	230 V 50 Hz			
Current consumption	15.2 A	17.4 A	19.6 A	21.7 A
Power	3500 W	4000 W	4500 W	5000 W
Maximum input water pressure	0.65 MPa			
Minimum input water pressure	0.04 MPa			
Output pressure	0 Bar			
Minimum water resistivity at 15°C	1300 Ωcm			
IP rating	IP25			
Minimum activation flow rate (approximately)	1.2 l/min	1.3 l/min	1.4 l/min	1.5 l/min
Energy efficiency class	A			

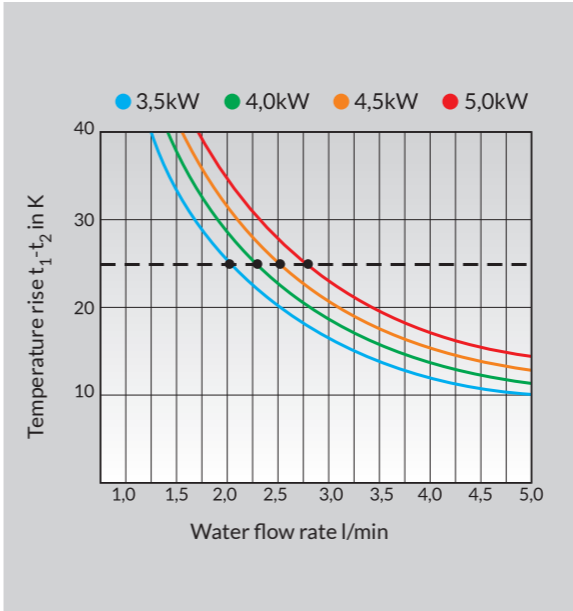

Heating capacity (power/water flow rate)

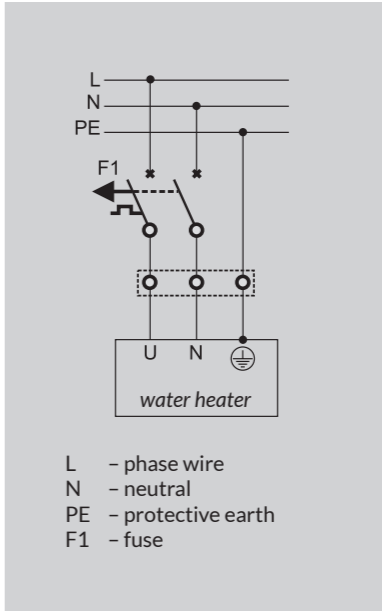

Electrical wiring

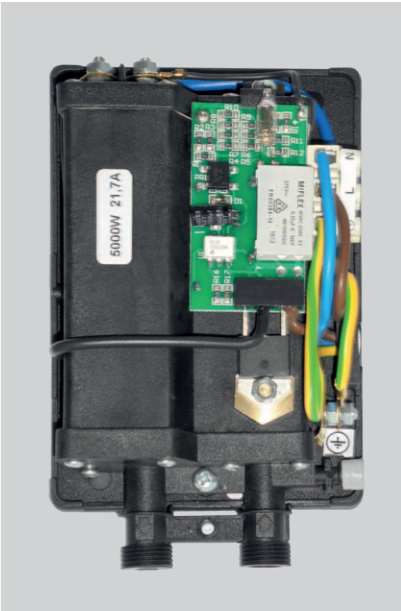

Internal structure

PERFECT 450P, 500P



Perfect 450P, 500P instant water heaters are special versions of Electronic Perfect 450, 500 water heaters intended to be installed in shower cabins. They are equipped with a shower set with a suitable fine-stream shower aerator . It enables to adjust the water stream to the heating capacity of the heater. Perfect Electronic 450P, 500P water heaters are equipped with a special housing of the protection class IP 25. It means that the heater is hermetic and there is no risk of electrical shock.

Application

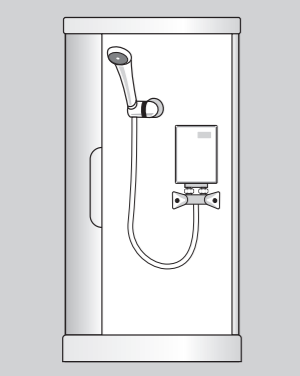

* recommended only with the manufacturer's shower head

- Shower*
4.5 kW to 5.0 kW

Advantages



Solid brass tap



Electronic switch system



Self-cleaning fine-stream aerator

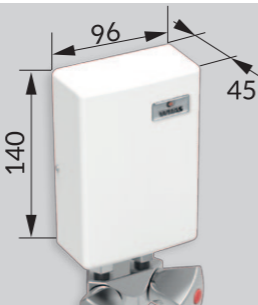

Very small dimensions



Valve to adjust the water temperature

Technical data

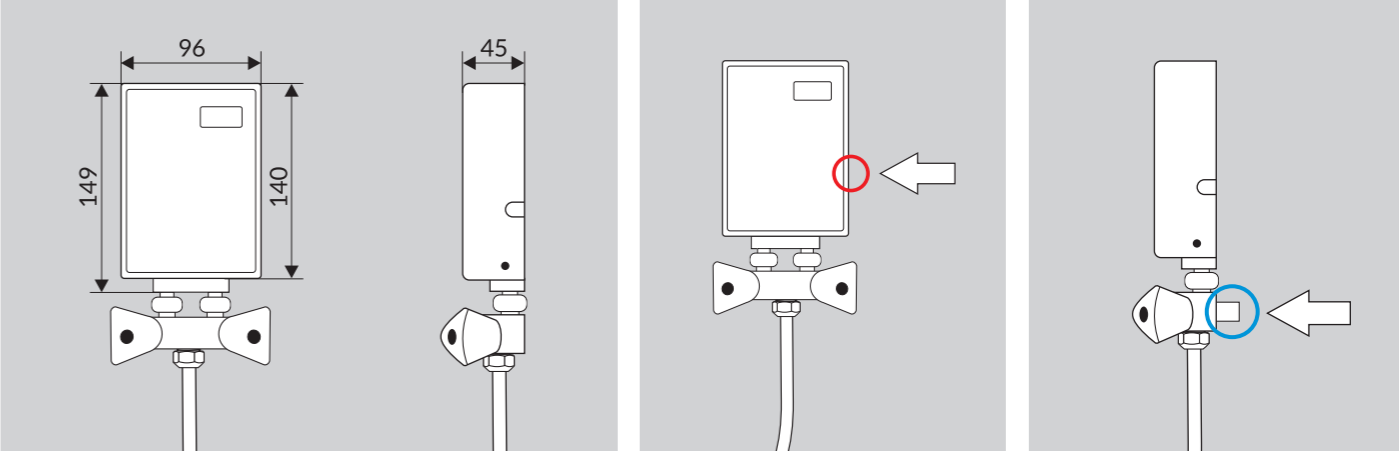

Dimensions

Power supply cable outlet

Water connection 1/2"

Heater type	Perfect 450P	Perfect 500P
Voltage	230 V 50 Hz	
Current consumption	19.6 A	21.7 A
Power	4500 W	5000 W
Maximum input water pressure	0.65 MPa	
Minimum input water pressure	0.04 MPa	
Output pressure	0 Bar	
Minimum water resistivity at 15°C	1300 Ωcm	
IP rating	IP25	
Minimum activation flow rate (approximately)	1.4 l/min	1.5 l/min
Energy efficiency class	A	

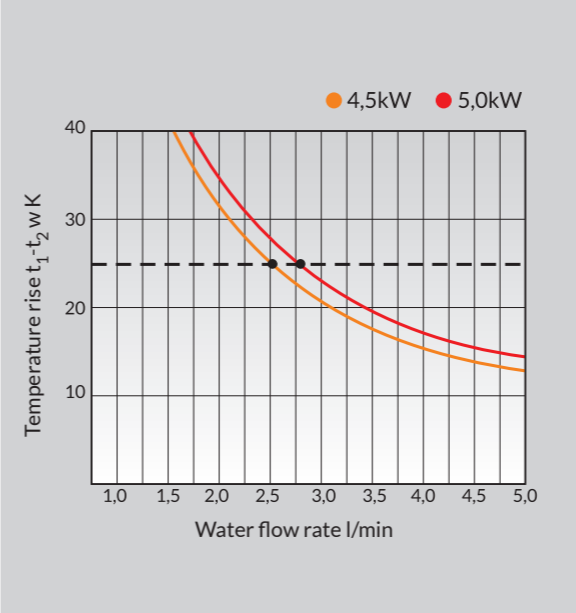

Heating capacity (power/water flow rate)

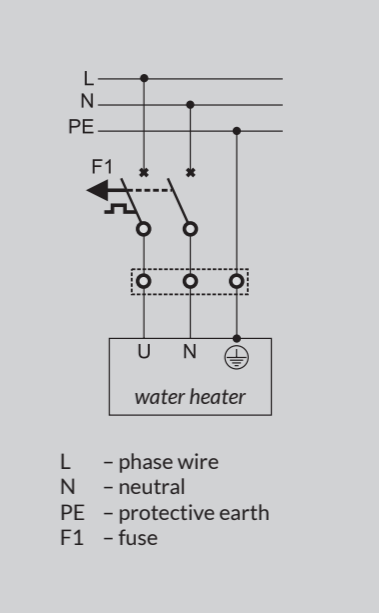

Electrical wiring



Internal structure

PERFECT MIX 3.5, 4.0, 4.5, 5.0, 5.5



The Perfect MIX 3.5 – 5.5kW devices are the economical versions of free-outflow (non-pressure) instantaneous water heaters at an attractive price. They are intended to supply hot water to washbasins and sinks. They are equipped with a ceramic mixing valve and an electronic control system for activating the device. As a result, all unreliable mechanical parts which are mounted in traditional water heaters such as switch contacts and a membrane have been eliminated. The reliability of the devices has been significantly enhanced in this way.

The heaters have a bare heating element. Consequently, hot water runs immediately after they are switched on. Moreover, the heaters are characterised by ease of assembly, resistance to scale, high heating capacity (above 98%) and high IP rating (25).

Application

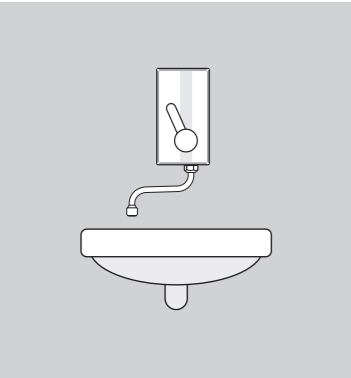

• Washbasin
3.5 kW to 4.5 kW

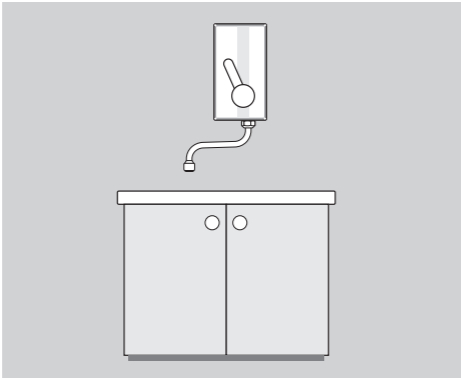

• Sink
4.0 kW to 5.5 kW

Advantages

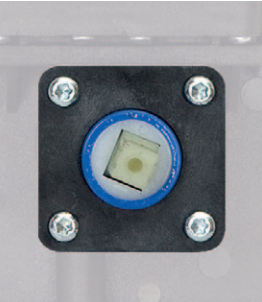

Ceramic mixing valve

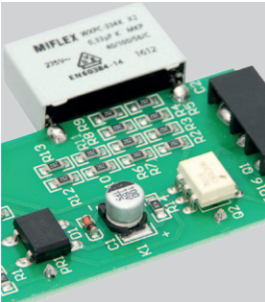

Electronic switching system



Self-cleaning fine-stream aerator

Technical data

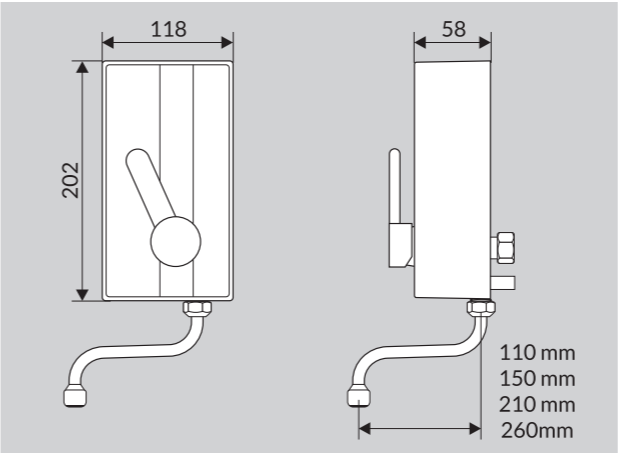

Dimensions

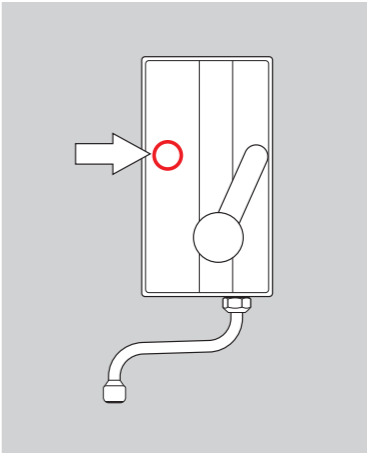

Power supply cable outlet

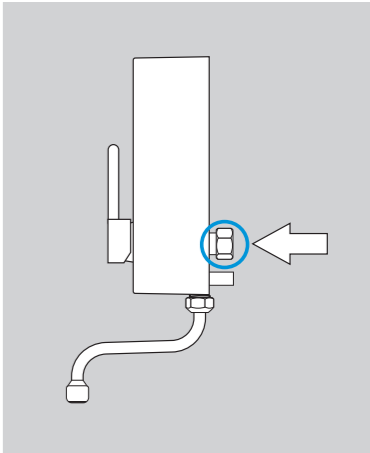

Water connection 1/2"

Heater type	Perfect MIX 3.5	Perfect MIX 4.0	Perfect MIX 4.5	Perfect MIX 5.0	Perfect MIX 5.5
Voltage	230 V 50 Hz				
Current consumption	15.2 A	17.4 A	19.6 A	21.7 A	23.9 A
Power	3500 W	4000 W	4500 W	5000 W	5500 W
Maximum input water pressure	0.65 MPa				
Minimum input water pressure	0.04 MPa	0.05 MPa	0.06 MPa	0.07 MPa	0.08 MPa
Output pressure	0 Bar				
Minimum water resistivity at 15°C	1300 Ωcm				
IP rating	IP25				
Minimum activation flow rate (approximately)	1.2 l/min	1.3 l/min	1.4 l/min	1.5 l/min	1.6 l/min
Energy efficiency class	A				

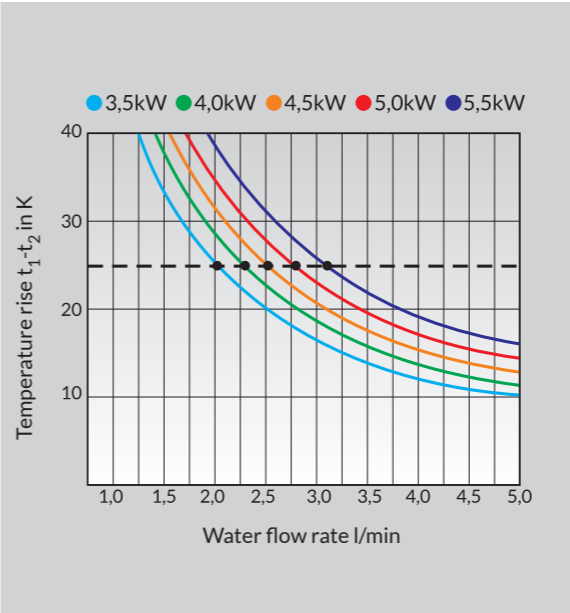

Heating capacity (power/water flow rate)

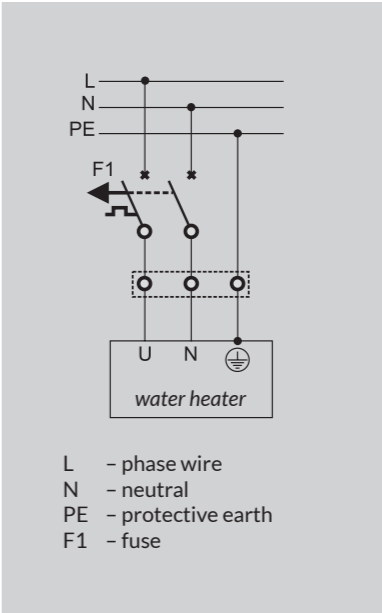

Electrical wiring



Internal structure

SMART 3.5, 4.0, 4.5, 5.0



SMART 3.5, 4.0, 4.5, 5.0 instantaneous water heaters are attractively priced, the smallest in size, devices of this type on the market. At the same time, their heating efficiency does not differ from the one in bigger models. They have such small dimensions because of their electronic control system which enables complete elimination of mechanic subassemblies which are used in other brands of heaters. Due to its small dimensions, the device can be easily installed and hidden, for example, in a cabinet under the washbasin. The heater is additionally equipped with a control valve which controls the water flow in order to reach the right temperature.

Application



• Washbasin
3.5 kW to 4.5 kW

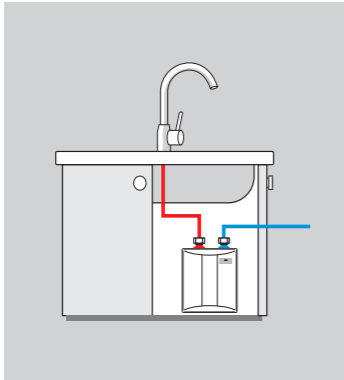

• Sink
4.0 kW to 5.0 kW

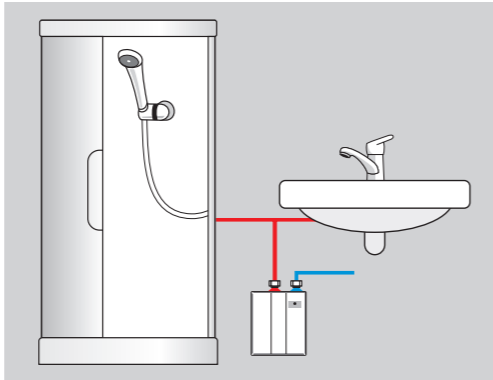

• Shower - washbasin*
4.5 kW to 5.0 kW

* recommended only
with the manufac-
turer's shower head

Advantages



Very small dimensions



Electronic switching system

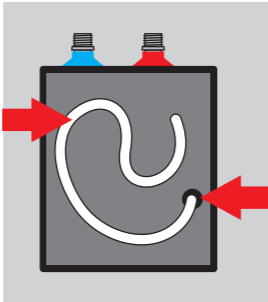

Ease of connecting the power
cable and hiding it under the
back case

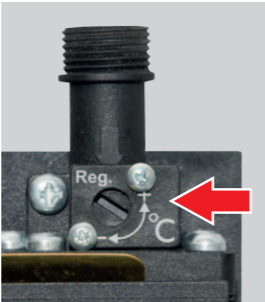

Valve to adjust the water
temperature

Technical data

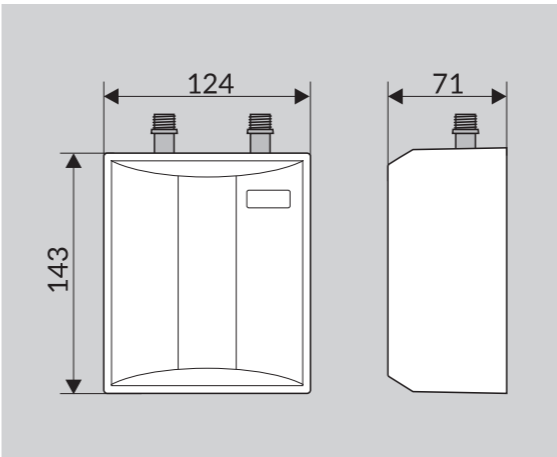

Dimensions

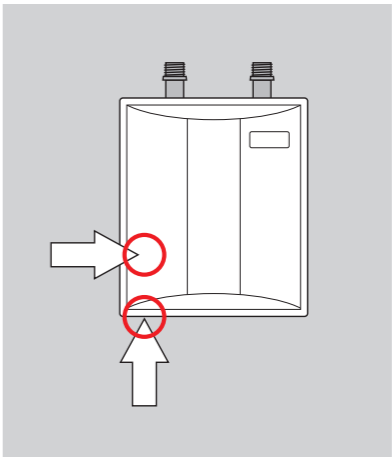

Power supply cable outlet

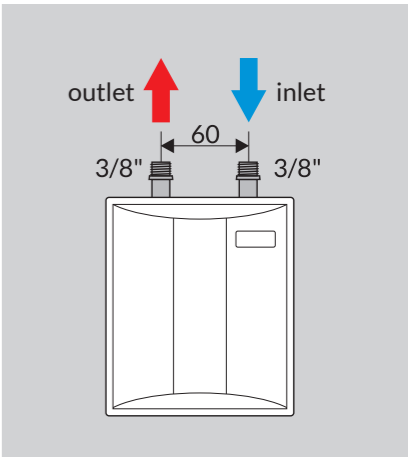

Water connection

Heater type	Smart 3.5	Smart 4.0	Smart 4.5	Smart 5.0
Voltage	230 V 50 Hz			
Current consumption	15.2 A	17.4 A	19.6 A	21.7 A
Power	3500 W	4000 W	4500 W	5000 W
Maximum input water pressure	0.65 MPa			
Minimum water resistivity at 15°C	1300 Ωcm			
IP rating	IP24			
Minimum activation flow rate (approximately)	1.1 l/min	1.25 l/min	1.4 l/min	1.5 l/min
Energy efficiency class	A			

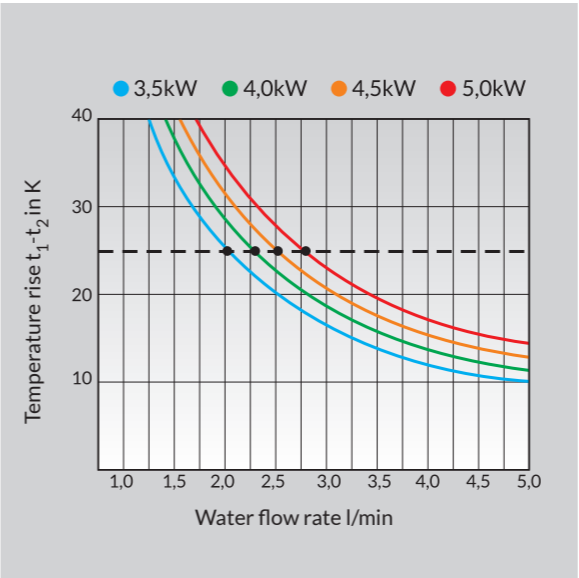

Heating capacity (power/water flow rate)

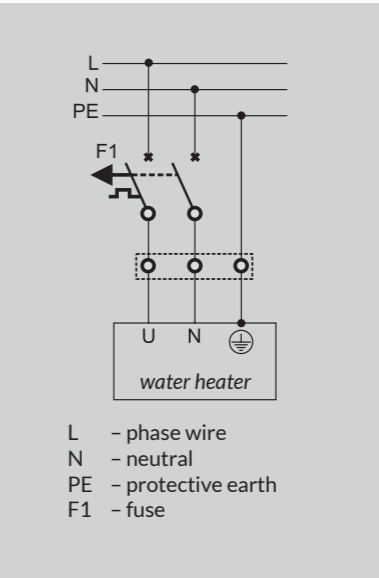

Electrical wiring

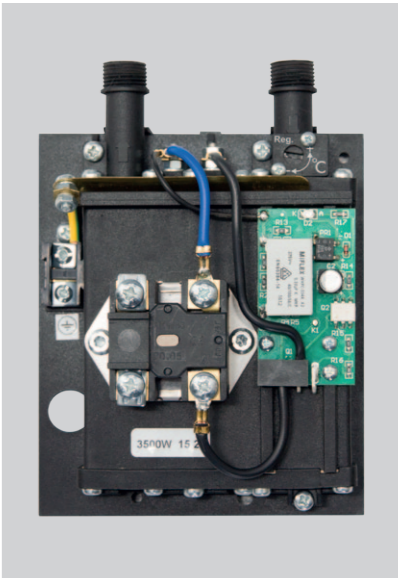

Internal structure

PERFECT 3500, 4000, 4500, 5000, 5500



Perfect 3500, 4000, 4500, 5000, 5500 instantaneous water heaters are 3,5, 4, 4,5, 5, 5,5 kW heaters designed for operation on 230V. They are intended to supply hot water to such single draw-off points as washbasins, sinks, showers (with the recommended manufacturer's shower set). The structure of the heating element enables its constant exposure to pressure up to 0,65 MPa. Therefore, any kind of pressure tap battery can be fitted to the heater. The device is mounted by the use of flexible hoses with rubber gaskets. Small dimensions and ease of assembly make it possible to install it quickly and to hide it, for instance, in the bathroom cabinet under the washbasin. Traditional switching mechanism on the spiral heating element has been eliminated in order to reduce the size of the device and to improve its reliability. It has been replaced with the electronic one consisting of an electronic system controlling the heater's performance, a reed switch water flow sensor and an electronic power switch (triac).

Application

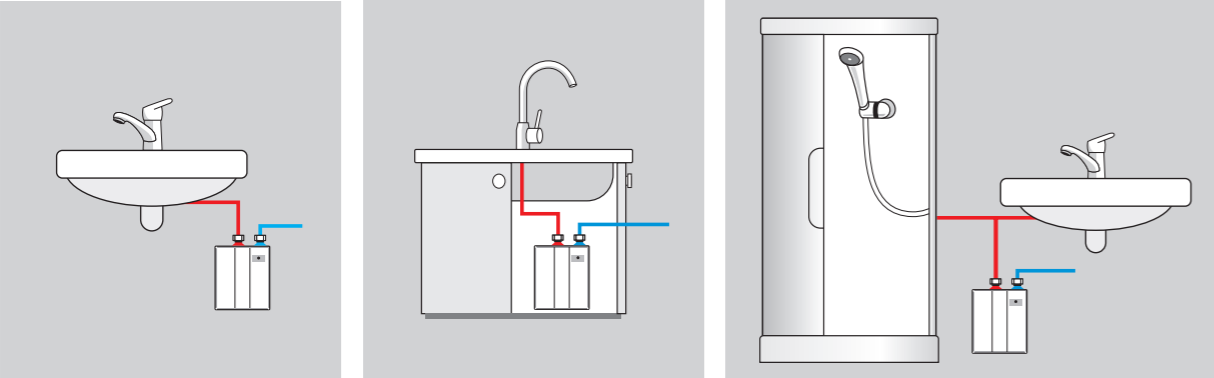

- Washbasin 3.5 kW to 4.5 kW
 - Sink 4.0 kW to 5.0 kW
 - Shower* - washbasin 4.5 kW to 5.5 kW
- * recommended only with the manufacturer's shower head*

Advantages

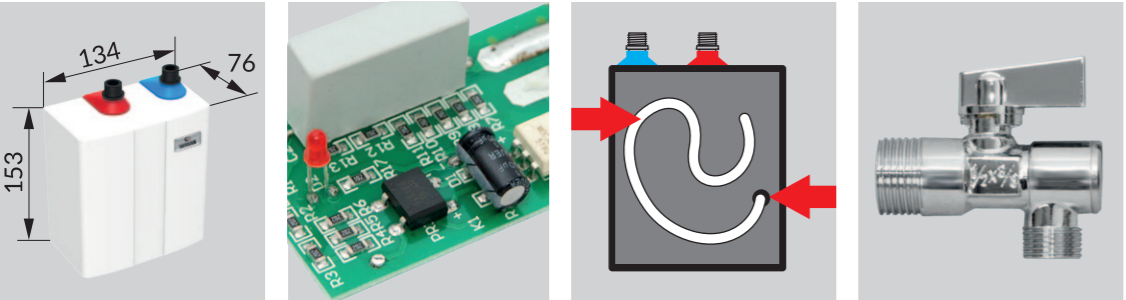

Small dimensions Electronic switching system Ease of connecting the power cable and hiding it under the back case A valve with a filter for setting the water temperature attached to the heater

Technical data

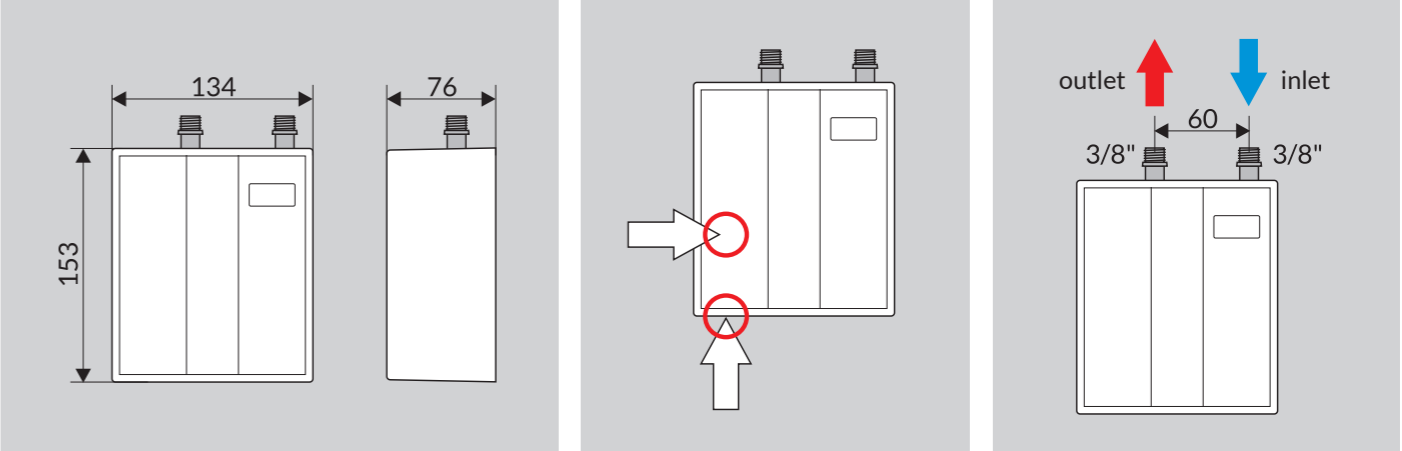

Dimensions Power supply cable outlet Water connection

Heater type	Perfect 3500	Perfect 4000	Perfect 4500	Perfect 5000	Perfect 5500
Voltage	230 V 50 Hz				
Current consumption	15.2 A	17.4 A	19.6 A	21.7 A	23.9 A
Power	3500 W	4000 W	4500 W	5000 W	5500 W
Maximum input water pressure	0.65 MPa				
Minimum water resistivity at 15°C	1300 Ωcm				
IP rating	IP24				
Minimum activation flow rate (approximately)	1.1 l/min	1.25 l/min	1.4 l/min	1.5 l/min	1.6 l/min
Energy efficiency class	A				

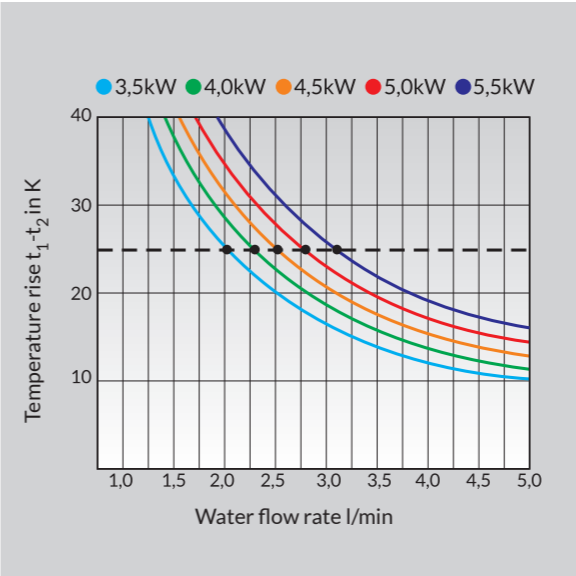

Heating capacity (power/water flow rate)

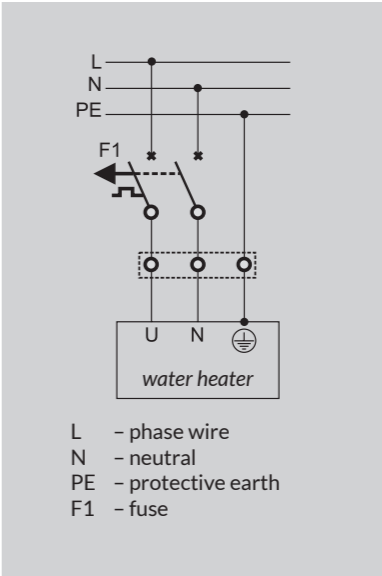

Electrical wiring

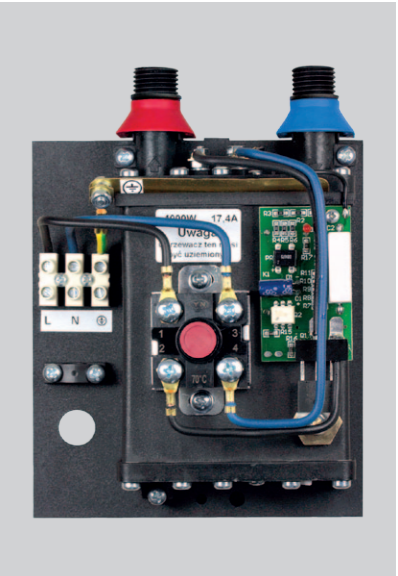

Internal structure

PERFECT 7000, 8000, 9000 (400V)



Perfect 7000, 8000, 9000 instantaneous water heaters are the 7, 8, 9 kW pressure heaters designed for operation on 400V. They are intended to supply hot water to washbasins, sinks and showers. Thanks to their significantly bigger power in comparison to other heaters of this type designed for operation on 230V, it is possible to use a single heater to supply hot water, for instance, to a washbasin and a shower. The only condition to be met is to install them no further than 2 metres away from each other. The structure of the heating element enables its constant exposure to pressure up to 0,65 MPa. Therefore, any kind of pressure tap battery can be fitted to the heater. The device is mounted by the use of flexible hoses with rubber gaskets. Small dimensions and ease of assembly make it possible to install it quickly and to hide it, for instance, in the bathroom cabinet under the washbasin. A three-wire system (two phase wires and protective earth) is the only requirement. Traditional switching mechanism on the spiral heating element has been eliminated in order to reduce the size of the device and to improve its reliability. It has been replaced with the electronic one consisting of an electronic system controlling the heater's performance, a reed switch water flow sensor and an electronic power switch (triac).

Application



• Washbasin
7.0 kW

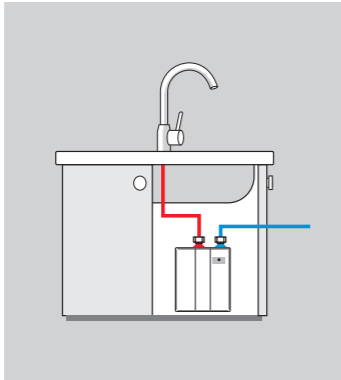

• Sink
7.0 kW to 8.0 kW

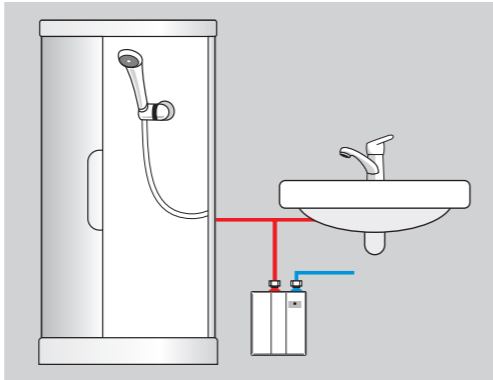

• Shower* - washbasin
8.0 kW to 9.0 kW

* shower head with small holes recommended

Advantages

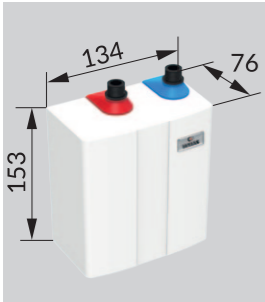

Small dimensions

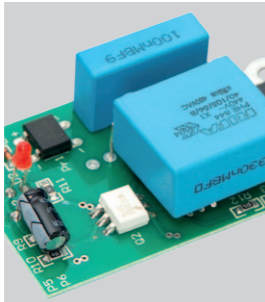

Electronic switching system

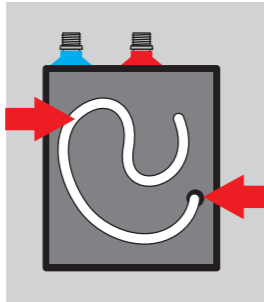

Ease of connecting the power cable and hiding it under the back case



A valve with a filter for setting the water temperature attached to the heater

Technical data

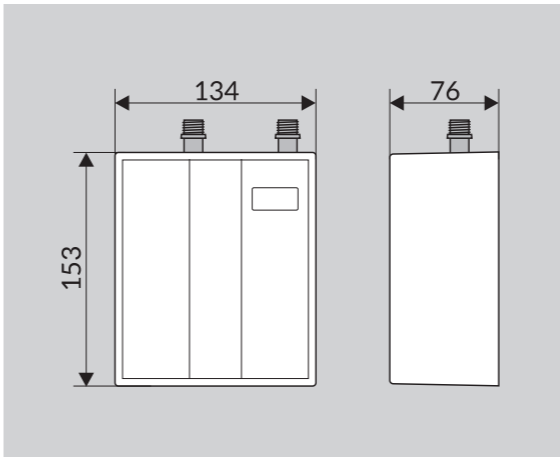

Dimensions

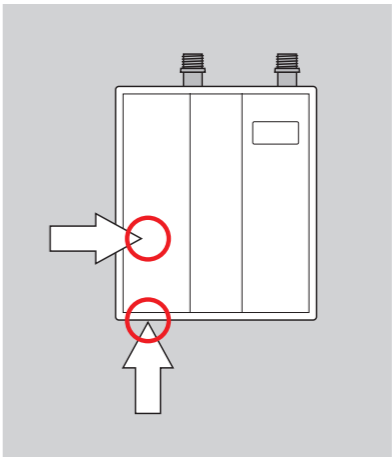

Power supply cable outlet

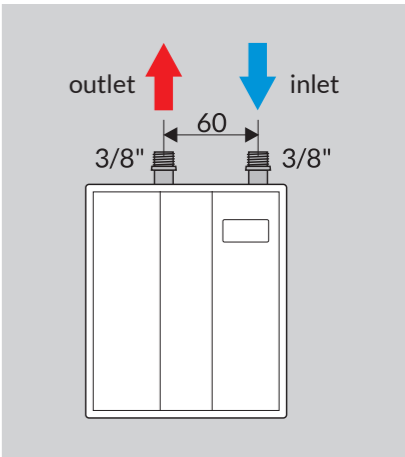

Water connection

Heater type	Perfect 7000	Perfect 8000	Perfect 9000
Voltage	400 V 50 Hz		
Current consumption	17.5 A	20.0 A	22.5 A
Power	7000 W	8000 W	9000 W
Maximum input water pressure	0.65 MPa		
Minimum water resistivity at 15°C	1300 Ωcm		
IP rating	IP24		
Minimum activation flow rate (approximately)	2.1 l/min	2.4 l/min	2.8 l/min
Energy efficiency class	A		

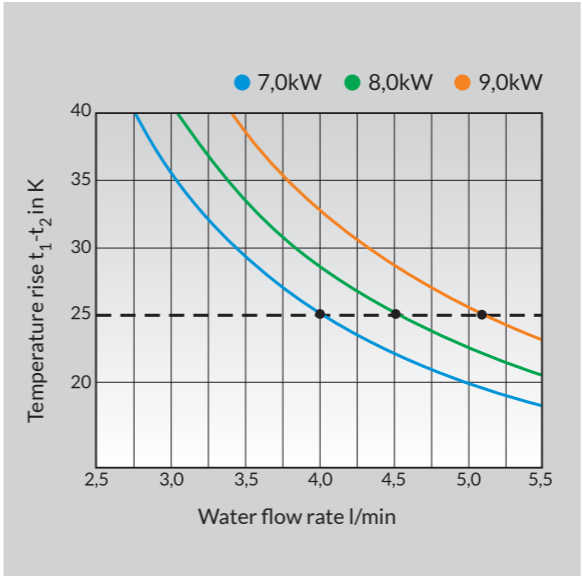

Heating capacity (power/water flow rate)

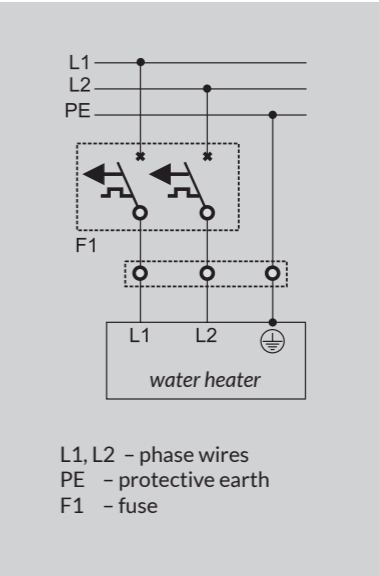

Electrical wiring

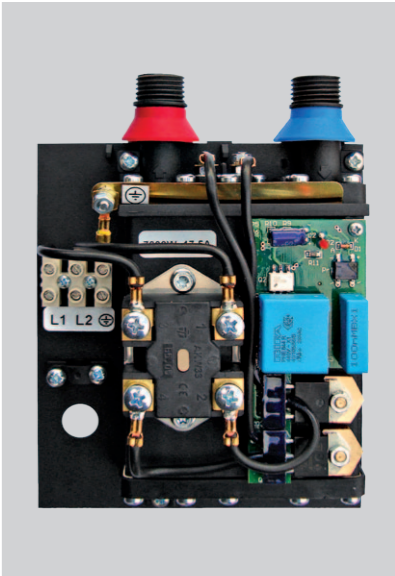

Internal structure

POW LCD MULTI (400V)



POW LCD MULTI instantaneous water heaters are devices intended to supply hot water to several draw-off points such as washbasins, baths, sinks, showers etc. They are equipped with an electronic control system which guarantees high efficiency and reliability. Additional benefits of using POW-LCD MULTI heaters are:

- accuracy of temperature regulation up to 0,5°C within the range of 30-60 °C
- large, easily legible LCD display
- three memory buttons for saving most frequently chosen temperatures
- the possibility of choosing the rated power of the heater resistance to scaling of the heating elements
- the system securing against damage caused by air bleeding
- instant hot water
- the possibility of supplying by pre-heated water e.g. by the solar installation
- system reacting to mains power drops ensuring stable water temperature
- the possibility of switching the LCD display to the diagnostic mode
- housing structure and flexible connectors make the assembly easy
- user-friendly device

Application

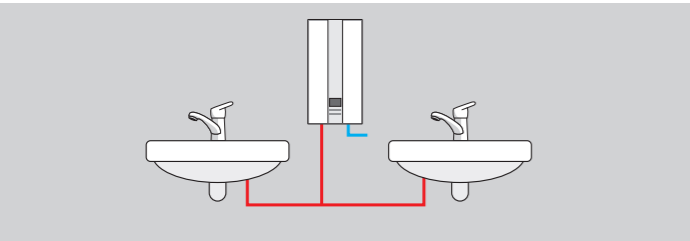

• Washbasins - 11 kW to 15 kW

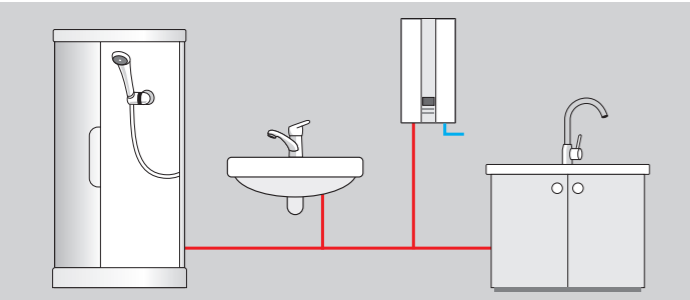

• Shower, washbasin, sink - 11 kW to 15 kW

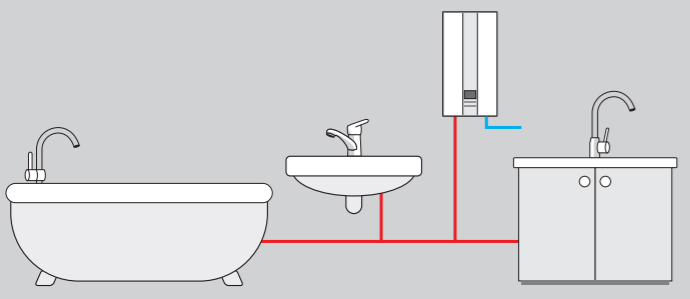

• Bath, washbasin, sink - 15 kW to 24 kW

Advantages



LCD display with a power consumption indicator

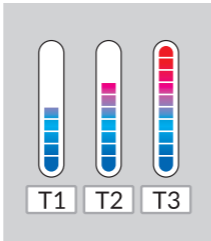

Three memory set-point temperatures

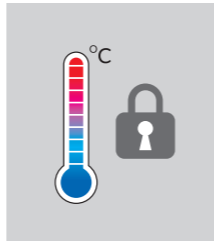

Temperature set-point blocking



Electronic control system

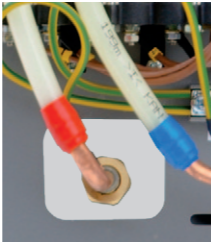

Flexible water connections making the installation easier



Hydraulic safety switch

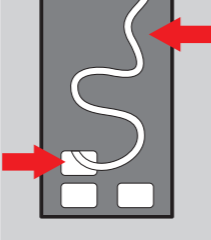

Ease of connecting the power cable and hiding it under the back case



Valve with mesh and magnetic filters attached to the heater

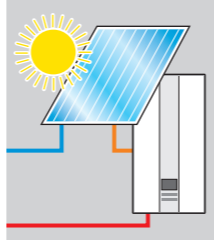

The possibility to heat up the water which was initially heated to 60 °C

Technical data

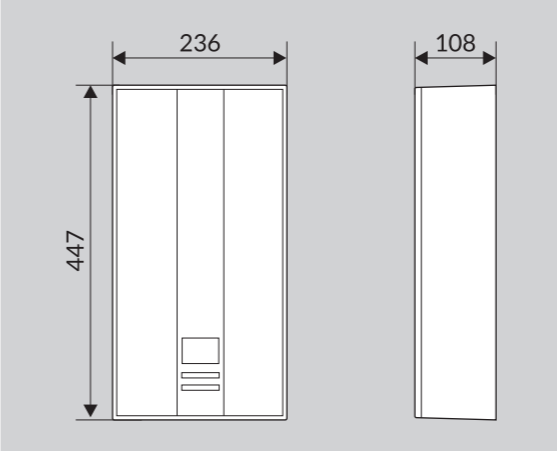

Dimensions

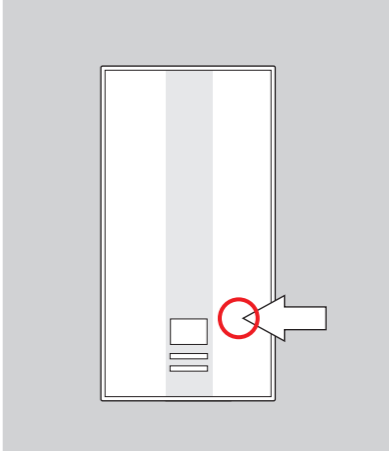

Power supply cable outlet

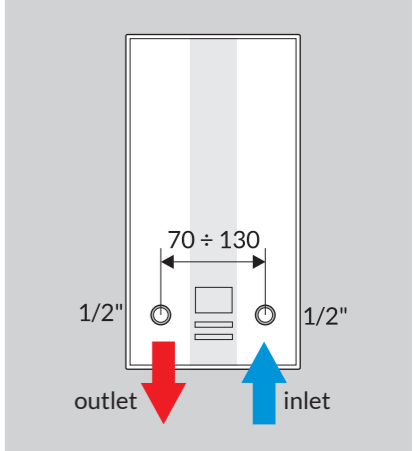

Water connection

Heater type	POW-LCD MULTI 11/13,5/15	POW-LCD MULTI 18/21/24
Voltage	400 V 3~	
Rated power	YES	YES
Power	11/13,5/15 kW	18/21/24 kW
Maximum current consumption	18/19,4/22,2 A	29/31/35,5 A
Minimum cross section of power supply cables	4 × 2,5 mm ²	4 × 6 mm ²
Heating capacity at 40°C temperature rise	3,9 / 4,8 / 5,4 l/min	6,6 / 7,6 / 8,7 l/min
Operating pressure range	0,1 – 0,6 MPa	
Maximum feed water temperature	60°C	
IP rating	IP 24	
Energy efficiency class	A	

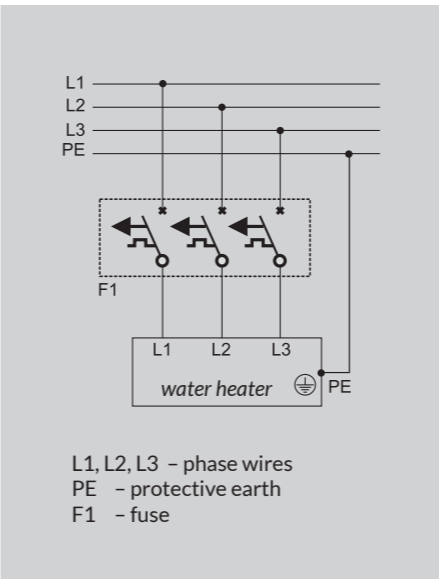

Electrical wiring

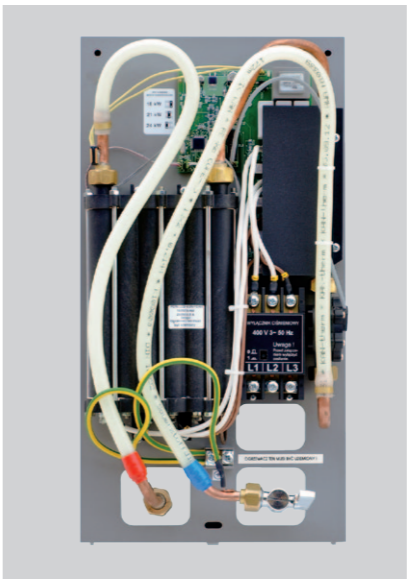

Internal structure POW LCD MULTI

POW LCD MULTI 2 (400V)



POW LCD MULTI 2 instantaneous water heaters are new devices intended to supply hot water to several draw-off points such as washbasins, baths, sinks, showers etc. They are equipped with an electronic control system which guarantees high efficiency and reliability. Additional benefits of using POW-LCD MULTI 2 heaters are:

- accuracy of temperature regulation up to 0,5°C within the range of 30-60 °C
- large, easily legible LCD display
- three memory buttons for saving most frequently chosen temperatures
- the possibility of choosing the rated power of the heater resistance to scaling of the heating elements
- the system securing against damage caused by air bleeding
- instant hot water
- the possibility of supplying by pre-heated water e.g. by the solar installation
- system reacting to mains power drops ensuring stable water temperature
- the possibility of switching the LCD display to the diagnostic mode
- housing structure and flexible connectors make the assembly easy
- user-friendly device

Application

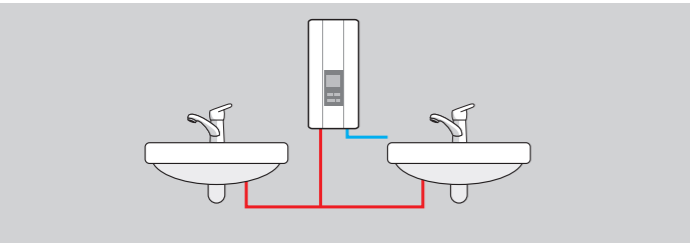

• Washbasins - 11 kW to 15 kW

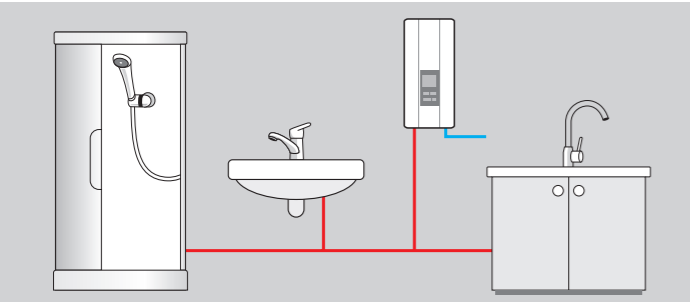

• Shower, washbasin, sink - 11 kW to 15 kW

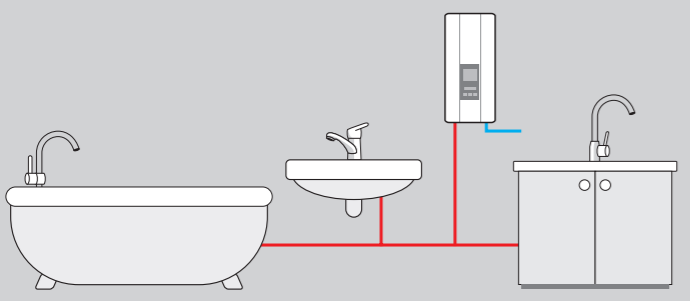

• Bath, washbasin, sink - 15 kW to 24 kW

Advantages



LCD display with a power consumption indicator

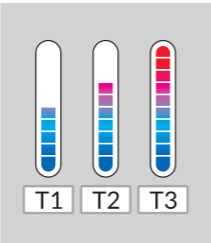

Three memory set-point temperatures

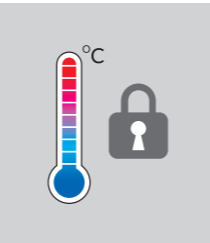

Temperature set-point blocking

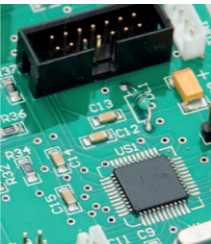

Electronic control system

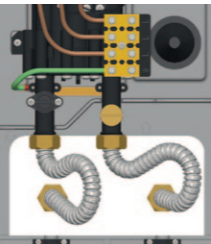

Flexible water connections making the installation easier



Hydraulic safety switch

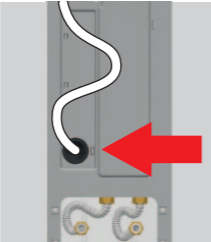

Ease of connecting the power cable and hiding it under the back case

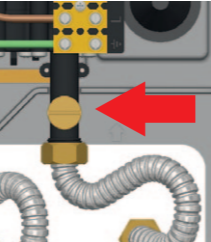

Water filter and flow adjustment valve integrated with the heater's heating body

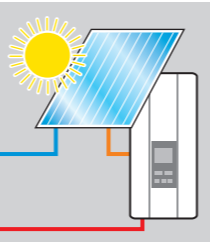

The possibility to heat up the water which was initially heated to 60°C

Technical data

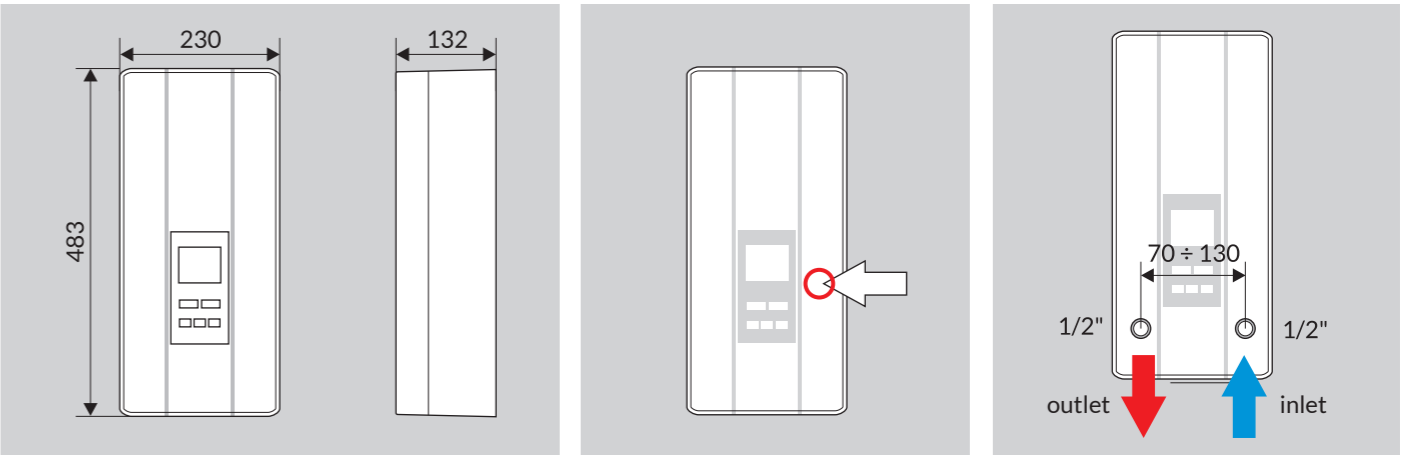

Heater type	POW-LCD MULTI 2 11/13,5/15	POW-LCD MULTI 2 18/21/24
Voltage	400 V 3~	
Rated power	YES	YES
Power	11/13,5/15 kW	18/21/24 kW
Maximum current consumption	18/19,4/22,2 A	29/31/35,5 A
Minimum cross section of power supply cables	4 × 2,5 mm ²	4 × 6 mm ²
Heating capacity at 40°C temperature rise	3,9 / 4,8 / 5,4 l/min	6,6 / 7,6 / 8,7 l/min
Operating pressure range	0,1 – 0,6 MPa	
Maximum feed water temperature	55°C	
IP rating	IP 24	
Energy efficiency class	A	

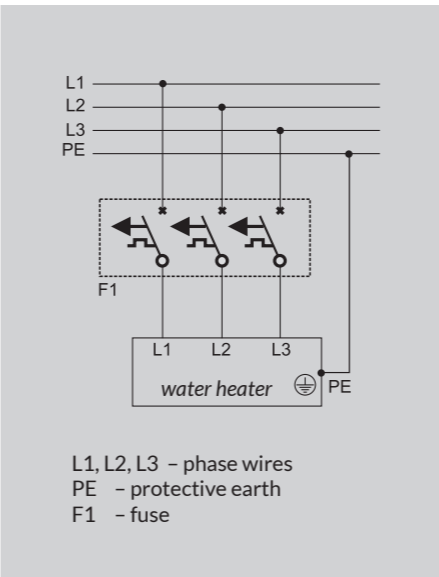

Electrical wiring

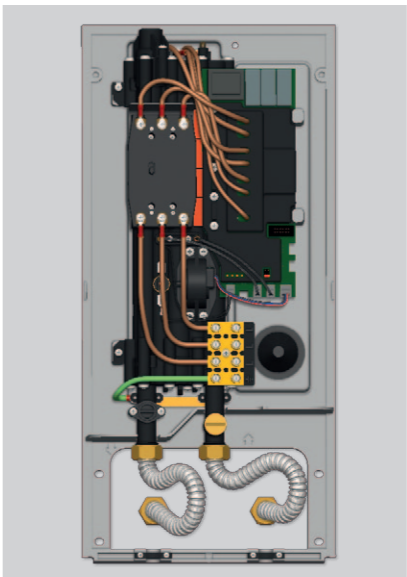

Internal structure POW LCD MULTI 2

POW 12H, 15H, 18H, 21H (400V)



- POW-H instantaneous water heaters with two-stage hydraulic activation are intended to supply hot water to several draw-off points. POW-H water heaters unlike other heaters with hydraulic control system have been additionally equipped with an electronic system ensuring higher reliability, durability and comfort of use. The main benefits of POW-H water heaters are:
- resistance to scaling of the heating elements
 - five modes controlling the heating power
 - the system securing against damage caused by air bleeding
 - instant hot water
 - housing structure and flexible connectors make the assembly easy
 - ease of assembly

Application

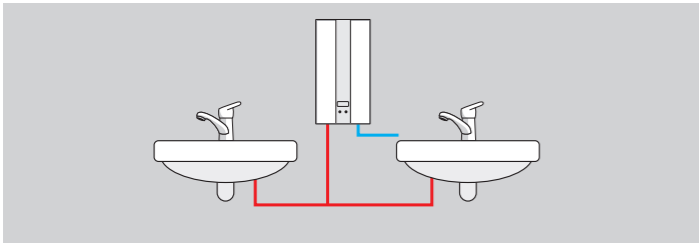

• Washbasins - 12 kW to 15 kW

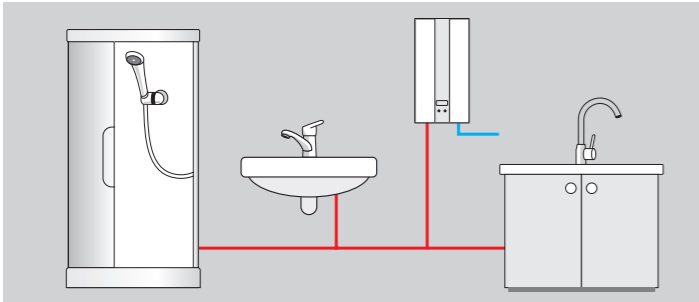

• Shower, washbasin, sink - 12 kW to 15 kW

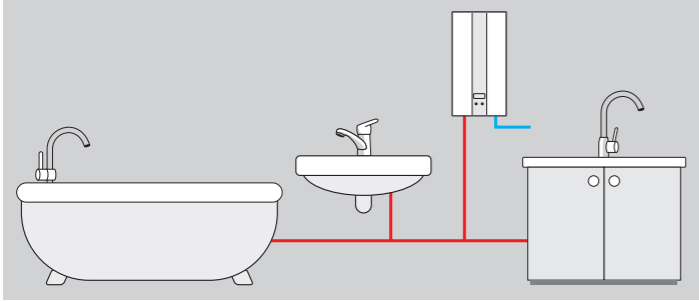

• Bath, washbasin, sink - 15 kW to 21 kW

Advantages



Five programs controlling the power of heating



Electronic control system



Hydraulic safety switch

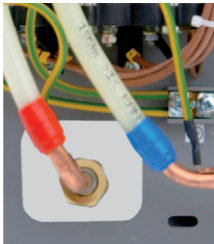

Flexible water connections making the installation easier

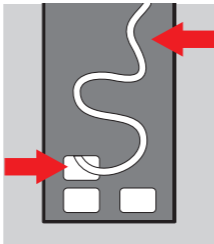

Ease of connecting the power cable and hiding it under the back case



Valve with mesh and magnetic filters attached to the heater

Technical data

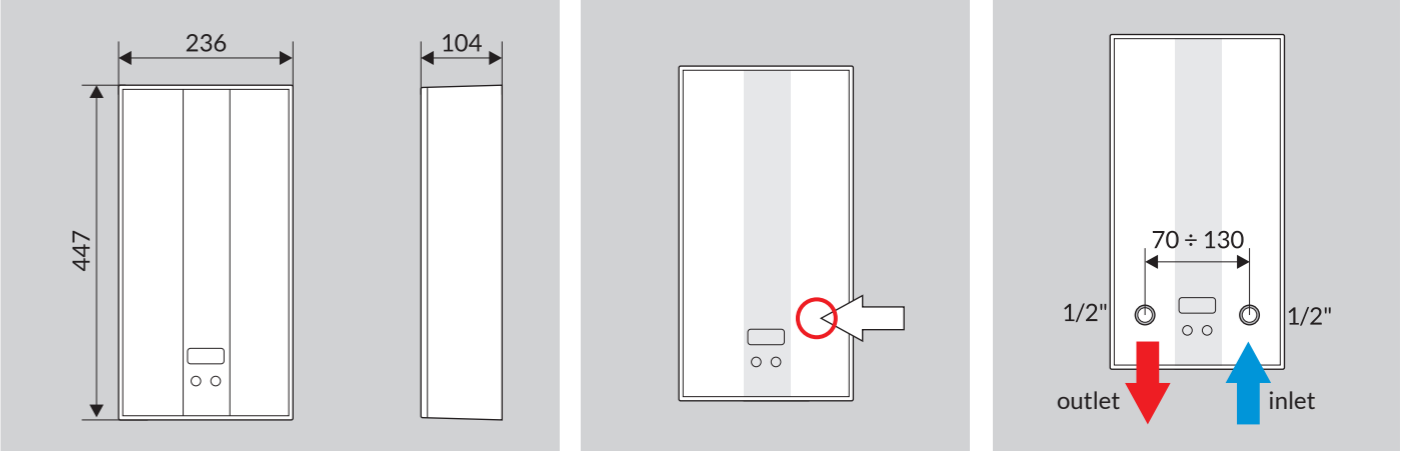

Heater type	POW 12H	POW 15H	POW 18H	POW 21H
Voltage	400V 3~			
Maximum current consumption	3×17.3 A	3×21.6 A	3×26 A	3×30.3 A
Power	12 kW	15 kW	18 kW	21 kW
Minimum cross section of power supply cables	4 x 2.5 mm ²	4 x 2.5 mm ²	4 x 4 mm ²	4 x 4 mm ²
Operating pressure range	0,2 – 0,6 MPa			
Minimum activation flow rate – the first power level	3 l/min	3.6 l/min	4 l/min	4.6 l/min
Minimum activation flow rate – the second power level	4.2 l/min	5.1 l/min	5.7 l/min	6.8 l/min
IP rating	IP 24			
Energy efficiency class	A			

Power level settings	POW 12H	POW 15H	POW 18H	POW 21H
	The first/second power level	The first/second power level	The first/second power level	The first/second power level
1	4/6 KW	5/7,5 KW	6/9 KW	7/10,5 KW
2	4/8 KW	5/10 KW	6/12 KW	7/14 KW
3	6/8 KW	7,5/10 KW	9/12 KW	10,5/14 KW
4	6/12 KW	7,5/15 KW	9/18 KW	10,5/21 KW
5	8/12 KW	10/15 KW	12/18 KW	14/21 KW

Input water temp.	Output water temperature 40°C			
	POW 12H	POW 15H	POW 18H	POW 21H
5°C	4.9	6.2	7.4	8.7
10°C	5.8	7.2	8.6	10
15°C	6.9	8.7	10.5	12.1

Input water temp.	Output water temperature 50°C			
	POW 12H	POW 15H	POW 18H	POW 21H
5°C	3.9	4.8	5.8	6.7
10°C	4.3	5.4	6.5	7.6
15°C	4.9	6.2	7.4	8.7

Heating capacity based on feed water temperature

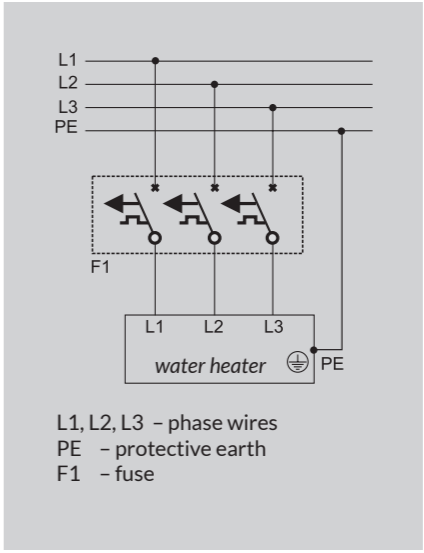

Electrical wiring

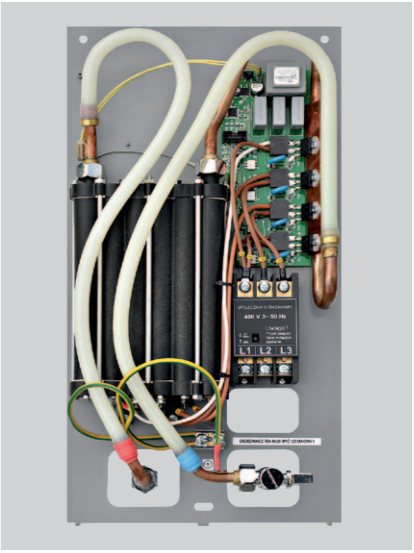

Internal structure POW H



POLAND
26-026 Morawica
Bilcza, ul. Szafirowa 35
tel.: + 48 41 302-26-10
tel.: + 48 41 302-22-32
fax: + 48 41 302-26-12
www.wijas.com.pl
e-mail: biuro@wijas.com.pl